

Main Plane in facilities (number 1, number 2 and land transportation Roughly built shelter) and elevation surface Plan.

The main improvement contents

Number 1 is transported by land by a roughly built shelter and the shape that it's put up from a roughly built shelter number 2, a roughly built shelter, improvement, it's arranged overall.
 The parking lot where number 1 is for market users in a roof of a roughly built shelter and a land transportation roughly built shelter, improvement.
 To strengthen a quality retention, sterilization cold sake seawater and a sherbet brackish ice supply equipment, improvement.
 A For shikoori to use for a display in summertime of difficult shellfish, low temperature chamber, improvement.
 LEDs of energy-saving equipment of illumination is introduced and a environment load is reduced.

Utilization plan of Facilities

Hand washing and washing of boots do person's entrance management and prevent bringing in of a pollution factor.
 Exhaust gases of entry of rolling stock in the Facilities is prohibited for a contamination control and an electric forklift is introduced.
 A flow of fishery products from a landing to shipment is one-way-sized and crossing pollution is prevented.
 It's carried in, a district is separated according to the use by which disposal of goods and shipment are preparations and carrying out, etc. and the health management is made appropriate.
 Clean environment is maintained by cleaning of establishments and equipment and thoroughness of washing and its situation is recorded.



The south side elevation view



Indoor image of the facility

The 2nd floor plan

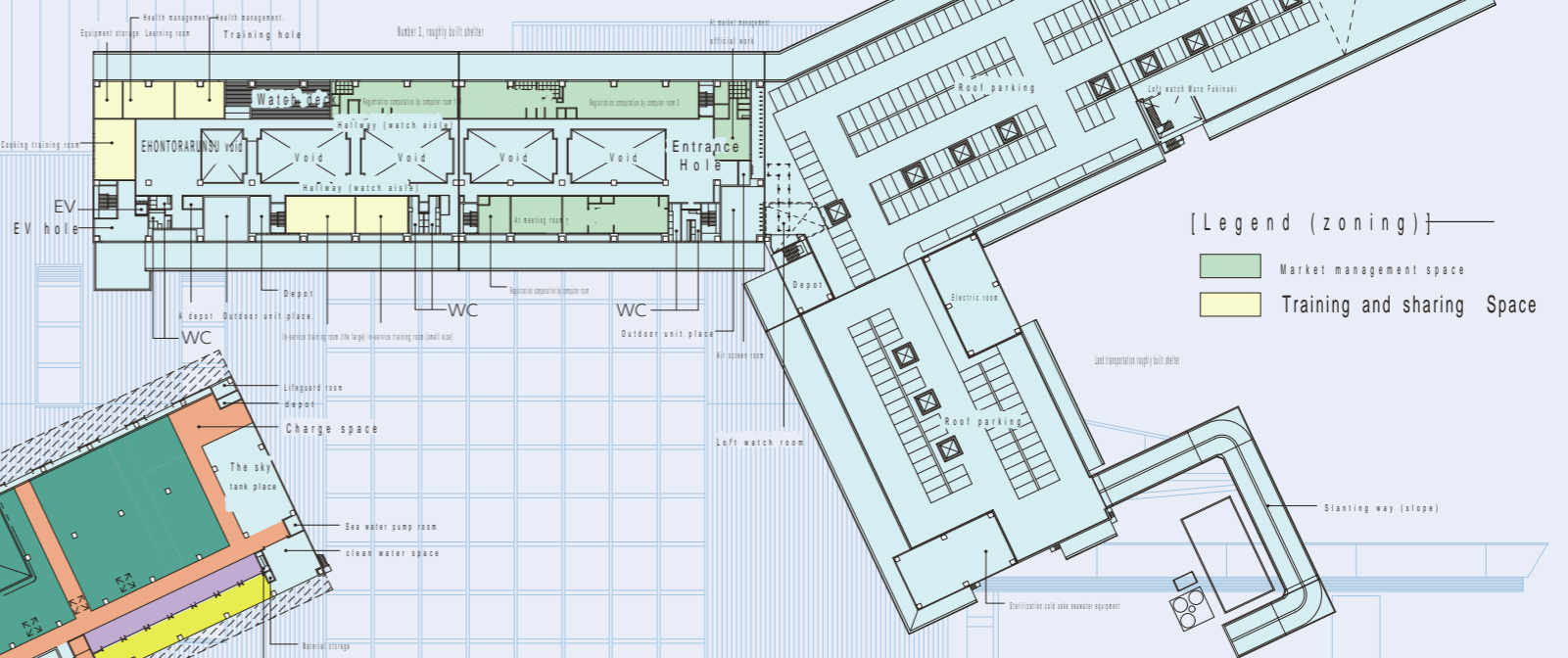

[Legend (zoning)]

- Market management space
- Training and sharing Space

The 1st floor plan

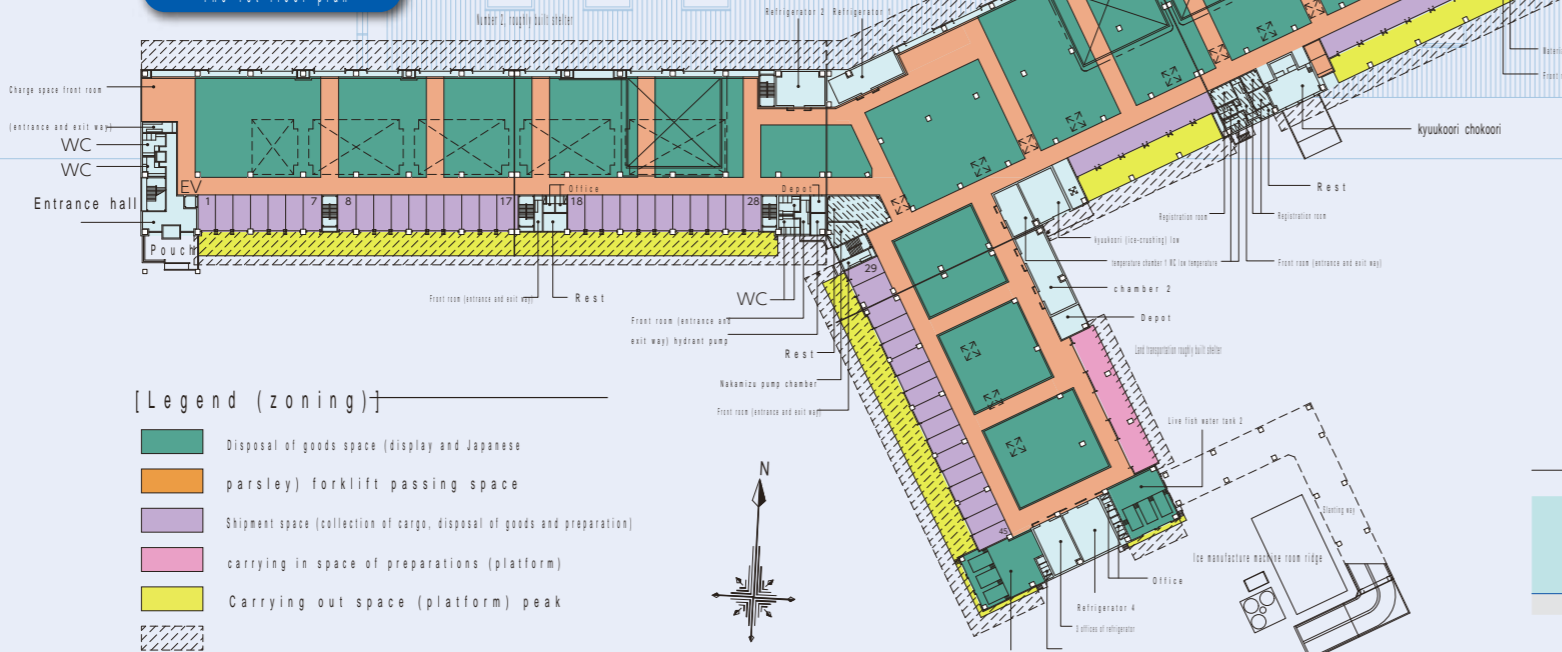

[Legend (zoning)]

- Disposal of goods space (display and Japanese parsley) forklift passing space
- Shipment space (collection of cargo, disposal of goods and preparation)
- carrying in space of preparations (platform)
- Carrying out space (platform) peak

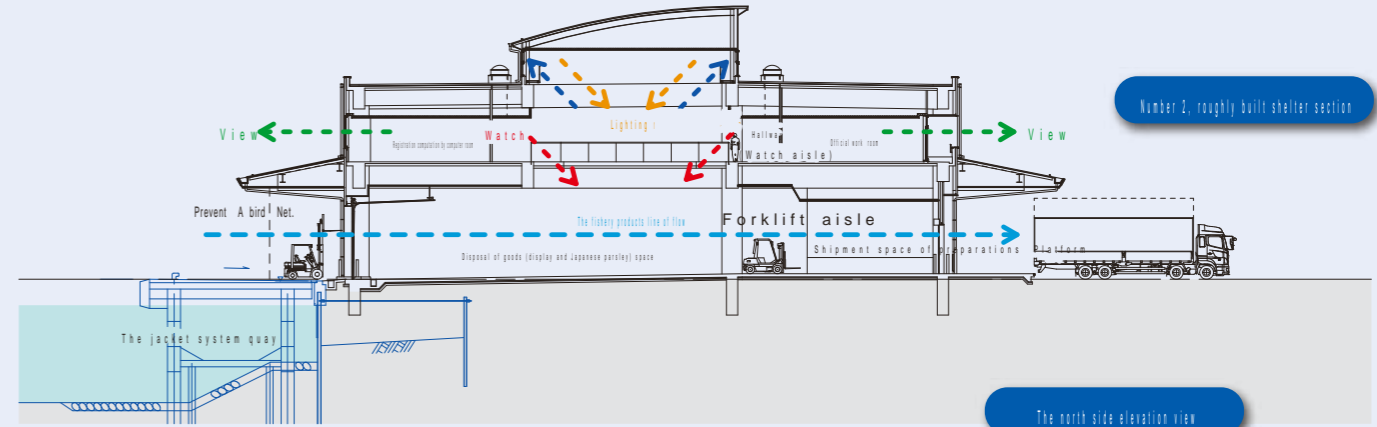

Number 2, roughly built shelter section

The north side elevation view

